



CE RoHS

## Description

The SL30 solar post top light is a multifunctional luminaire and it's IP66. It can be mounted on the round or square poles with different brackets options. This makes it perfect to use in parks, gardens, car parks etc. The fixture has charging progress bars, so you can see the battery power reserve at a glance. There are different working modes optional by remote control, such as microwave motion sensor, full brightness / half brightness, AUTO, 3H/5H/8H timer modes. Also can change the CCT by remote control, CCT is 3000K/4000K/5000K selectable.

## Key Features

- System efficiency up to 170lm/W.
- 5W /10W available
- Higher conversion mono-crystalline photovoltaic solar panel.
- Favorable charging speed when sufficient light offered.
- Support the most popular mounting type such as single strut, twin strut, post top, side entry, Straight-arm.
- Power adjustable by remote control ( full brightness mode running on 100% power, half brightness mode running on 50% power )
- 3000K/4000K/5000K selectable by remote control.

## Applications

- Roadway
- Parks
- Public square
- Private garden
- Residential area
- Walkway

Electrical Information		
Model No.	CPS-SL30-005	CPS-SL30-010
Power Consumption (W)	5	10
Battery	LiFePO4	
Battery Capacity (WH)	23.04	57.6
Solar Panel	Mono-crystalline	
Solar Panel Wattage (W)	10	20
Charging Time (Hours)	> 4.4	> 5.4
Operating Time	Default Working Mode(AUTO): 1day	
	Full brightness working mode: 1day	
	Half brightness working mode: 2days	
	Motion working mode: 3~5days	
Solar Charge Controller	PWM	

\* The tolerance for power is  $\pm 10\%$ .

Optic Information		
LED Type	LED 2835	
Luminous Flux (lm)	up to 850	up to 1700
Efficacy (lm/W)	up to 170	
Correlated Color Temperature	3000K/4000K/5000K selectable (Default 4000K)	
Color Rendering Index	Ra70 (Ra80 optional)	
Beam Angle	R01207, R01209	
UGR level	N/A	

\* The tolerance for luminous flux is  $\pm 10\%$ .

Dimensions and Mount	
Product Dimension (mm)	$\phi 421 \times 77$ (Lamp body)
Luminaire Net Weight (kg)	6.8
Export Carton Size (mm)	445x445x100mm (Lamp body)
Gross Weight (kg)	8.8
Mounting Option	Single strut mounting, Twin strut mounting, Straight-arm mounting Post top mounting, Side entry mounting
Material	Aluminum alloy Tempered Glass+Polycarbonate Optical Lens
Finish	Powder coating
Fixture Color	Black(RAL9005)
EPA(m <sup>2</sup> )	0.14
IK Rating	N/A
IP Rating	IP66
Category of corrosion	C3 (ISO 9223:2012)

\* The tolerance for weight is  $\pm 6\%$ .

Lifespan and Warranty	
Operating Temperature (°C)	0 to +50
Lifespan of LED @Ta=25°C (hours)	L90-80000
	L80-170000
	L70-270000
Warranty (years)	Battery 3-year, Other accessories 5-year warranty

### New Features

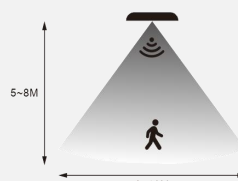

Sensor detection range



Max.10M

Point the remote control at the fixture

*\* Please consult us for details.*

## Photometry

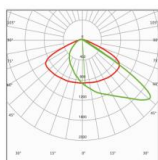

R01207  
(137°x50° tilt 50° )

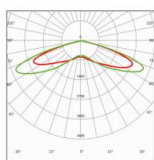

R01209  
(156°x156° )

## Intelligent Control Mode

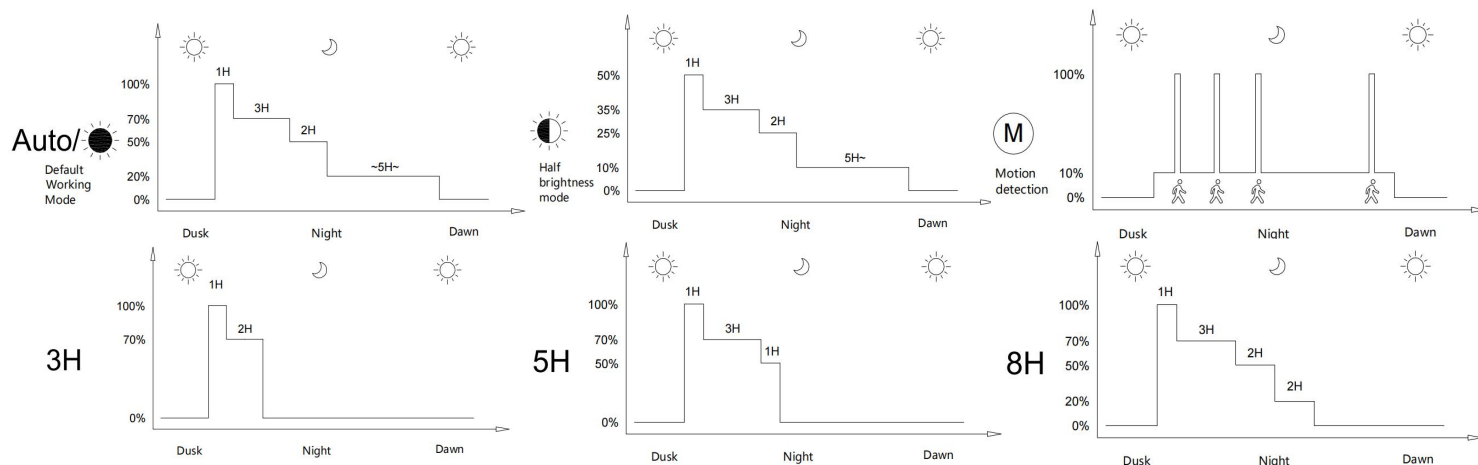

Note: the working hours depend on the local weather and Sunshine.

## Mounting Options



Single strut mounting



Twin strut mounting







Straight-arm mounting



Side entry mounting



Post top mounting

Mounting Option	Min.Power	QTY/CTN	NW (± 0.3kg/ ± 0.66Lbs )	GW (± 0.3kg/ ± 0.66Lbs )	Export Carton Size(mm/inch)
Single strut		5	8kg (17.6Lbs)	11kg (24.2Lbs)	520x520x275mm (20.07x20.07x25.39")
Twin strut		5	9kg (19.8Lbs)	12.5kg (27.6Lbs)	500x550x335mm (19.7x21.6x13.2")
Straight-arm bracket		15	18kg (39.7Lbs)	21.3kg (47Lbs)	610x540x240mm (24.0x21.3x9.4")
Slip fitter bracket		15	18kg (39.7Lbs)	20.1kg (44.3Lbs)	420x270x335mm (16.5x10.6x13.2")

\* The light distribution will be different due to the different mounting brackets.

\* Heat sink A : for single strut brakcet / straight-arm bracket / slip fitter bracket.

Heat sink B : for twin strut brakcet / single strut brakcet / straight-arm bracket / slip fitter bracket.

## Dimensions

Unit: mm/inch

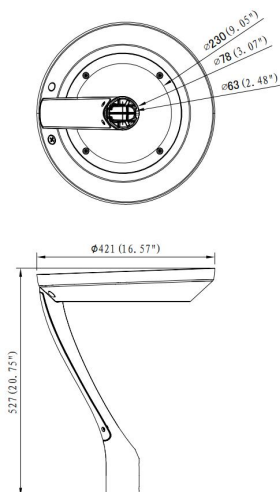

Single strut mounting

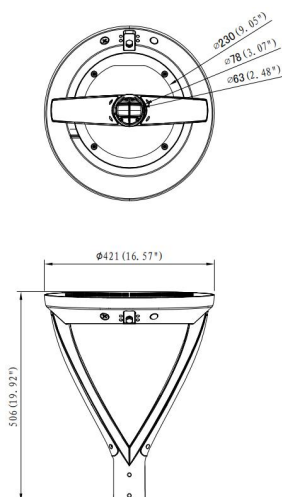

Twin strut mounting

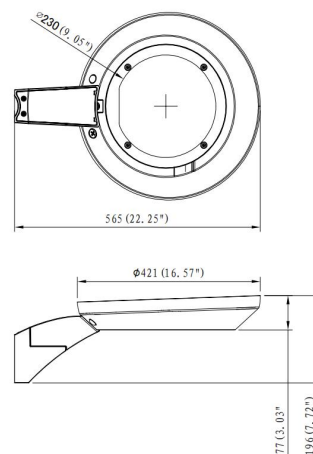

Straight-arm mounting

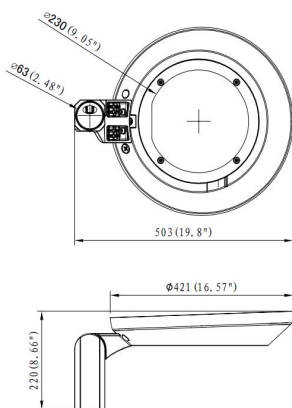

Post top mounting

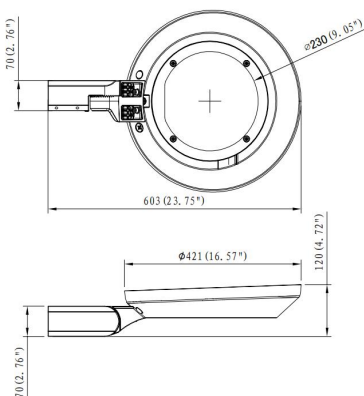

Side entry mounting

## Accessories



### Single strut

ADC12 materials with outdoor powder coating.  
for dia.60mm pole.  
Compatible with heat sink A/B.  
Code:SP-R40-04



### Twin strut

ADC12 materials with outdoor powder coating.  
for dia.60mm pole.  
Compatible with heat sink B.  
Code:SP-R40-05



### Straight-arm bracket

ADC12 materials with outdoor powder coating.  
for dia.76mm round pole,  
for 74mm square pole.  
Compatible with heat sink A/B.  
Code:SP-R40-02



### Slip fitter bracket

ADC12 materials with outdoor powder coating.  
for dia.60mm pole.  
Compatible with heat sink A/B.  
Code:SP-R40-03



### Remote control

Remote controller for solar light  
code: HY-003